



SR2 SERIES

SR2 offers the state of the art Radio Frequency (RFID), Bluetooth technology and stable mechanical design to ensure guest satisfaction.

SR2 has different handle connection systems that prevents damaging by guests. SR2 offers stability with desing.

Anti-Cloning technology, European std mortise options.

Hidden mechanical override key option in case of emergency.

ELEKTRONİK KİLİT Özellikler



Lock Unlocking Method	Card & Bluetooth. Remote access with Gateway
Mechanical Key	Available
Start Time	<1 second
Create Admin Account	Available
Unlock via Card	Available
Unlock via Bluetooth from a mobile	Available
Operating Voltage	6V, 4 pieces of Akalin
Static Power Consumption	<4μA
Dynamic Power Consumption	200 mA
Operating Temperature	Between -20 °C and 50 °C
Maximum Humidity	≤ %80
Door Thickness	38~60mm

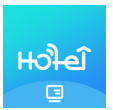
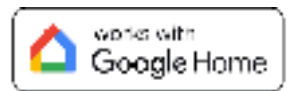

Sensor Distance	3~5cm
Lock Weight	3.5kg
Battery Life	12~16 months
Voltage Alarm	Yes
Lock Alarm	Available
TTLOCK and TTHOTEL	Yes

Model	Mortise (Lock Body) Features					Battery Type	Motor	Weight
	Mortise	Min. Door Thickness	Mortise Depth	Center (mm)	Mortise Thickness			
SR2								
E2	Euro	32 mm	85 mm	55 mm	23mm	4xAA	In Mortise	2,30
A3	ANSI	36 mm	90 mm	62 mm	26mm	4xAA	In Mortise	2,30

SR2 Series Mortise Options

A1
Mortise

E-2
Mortise

Anti Friction Latch	✓	✓
Anti-Pick (Theft) Latch	✓	✓
Deadbolt	✓	✓
Anti-Panic	✓	✓
Auto-Locking Function	✗	✗
Min Door Thickness	40 MM	30 MM
Cylinder Type	ANSI	EURO
Electronic DND Function	✓	✓



Gateway / Bridge Features

- The lock can be remotely managed and unlocked (e.g., from a reception) using Bluetooth, card, or gateway.
- Keys can be created for unlocking the lock from other mobile devices.
- Opening logs can be tracked remotely.
- You can view the lock's battery status remotely.
- All settings are configured via the TTLock and TTHotel software. It is easy to use.
- With the gateway, you can add scenarios to your locks using Google Home Assistant and Amazon Alexa and benefit from the remote voice command unlocking feature.

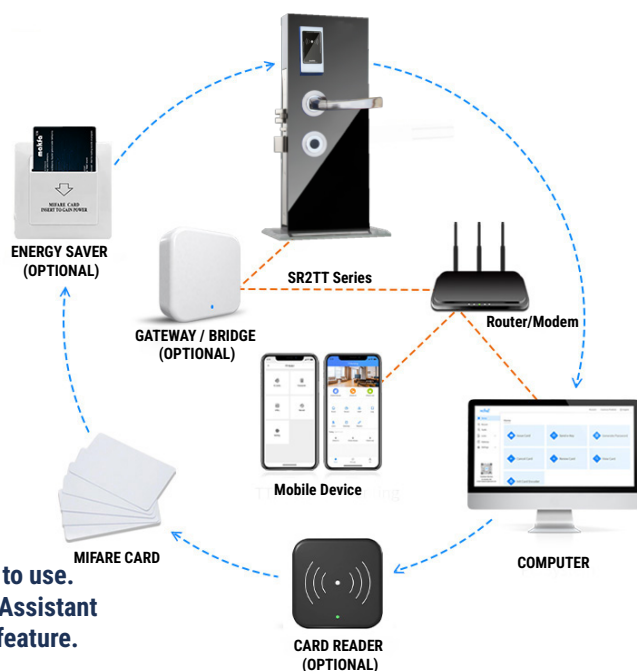

SR2 RFID ELECTRONIC LOCKING System Features

- Stable reading speed
- Long Battery Life. Microwave card detection
- Works with paper card, ISO cards, wristbands, keychains etc
- Even dia 14mm paper label cards can be identified
- Powered by 4pcs of Alkaline AA batteries. 2 years battery life
- Led and sound allerts
- Classic Hotel Lock Desing

Body / Lock Features

- SUS 304 Stainless Steel Body
- Optional Outdoor PVD Coating
- Special Installation System to ensure the stability
- Very easy to maintain.
- Extra Strong Desing
- EUR 55x75 or ANSI Mortise Options
- Compatible with upto 120 min. Fire rated doors
- CE, FCC, ISO
- Anti-Friction Latch
- DND Function and Anti-Panic Function
- Anti-Pick (Theft) Latch
- EUR Std Cylinder for E1-E2 Mortises
- ANSI Special Cylinder for A1-A2 Mortises